

UNCONTROLLED DOCUMENT

29F0428-0T0-10



PHYSICAL DIMENSIONS:

A	10.88 [.428]	+ 0.15 [.006]
B	10.88 [.428]	+ 0.15 [.006]
C	10.57 [.416]	+ 0.20 [.008]
D	7.62 [.300]	+ 0.13 [.005]
E	2.54 [.100]	+ 0.05 [.002]
G	3.18 [.125]	+ 0.38 [.015]
H	11.43 [.450]	+ MAX

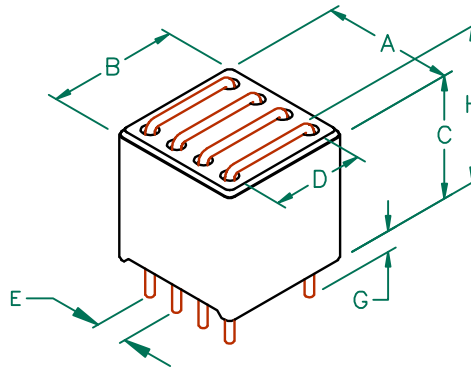

ELECTRICAL CHARACTERISTICS:

	Z @ 100MHz (Ω)	DCR (Ω)	Rated Current
Nominal	342		
Minimum	257		
Maximum	427	0.01	10,000 mA

NOTES: UNLESS OTHERWISE SPECIFIED

1. BULK PACKED 910 per CASE.
2. COMPONENTS SHOULD BE ADEQUATELY PREHEATED BEFORE SOLDERING.
3. TERMINATION FINISH IS 100% TIN.

HOLE PATTERN FOR THRU-HOLE INSERTION

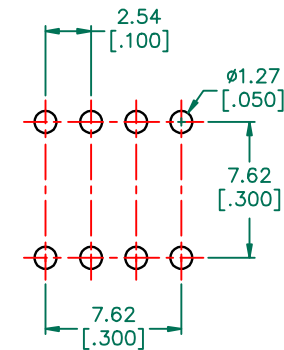
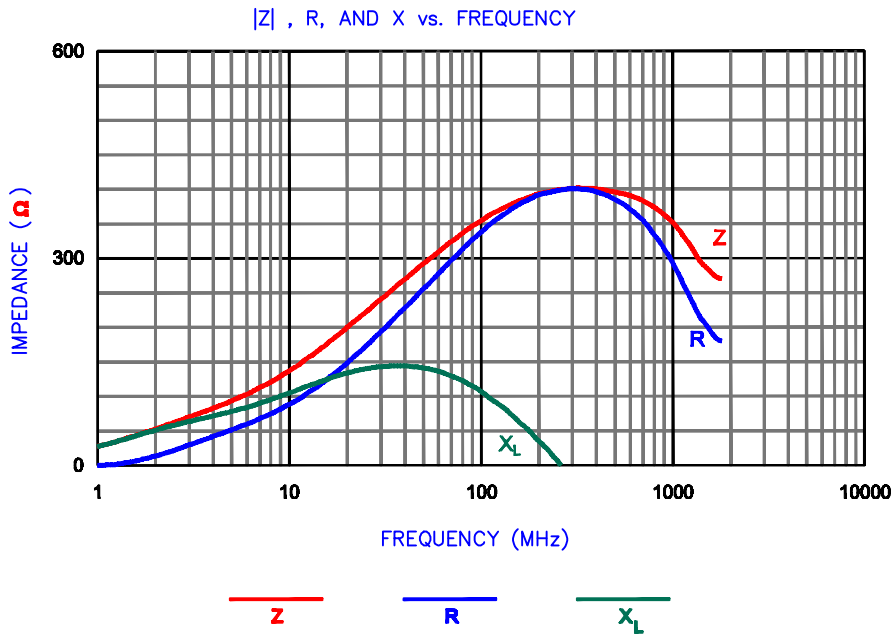

DIMENSIONS ARE IN mm [INCHES]				This print is the property of Laird Tech. and is loaned in confidence subject to return upon request and with the understanding that no copies shall be made without the written consent of Laird Tech. All rights to design or invention are reserved.			
PROJECT/PART NUMBER:				29F0428-0T0-10			
REV C				PART TYPE: CNZ ASSEMBLY		DRAWN BY: JRK	
B UPDATE COMPANY LOGO				DATE: 04/30/04		SCALE: NTS SHEET: 2 of 3	
A ORIGINAL DRAFT				DATE: 04/30/04		TOOL # H0428	
REV DESCRIPTION				DATE		INT	
				DATE: 10/21/08		CAD # 29F0428-0T0-10-C-2	

HP 4396A Network/Spectrum Analyzer
HP 43961A Impedance Test Kit, HP 16192A Test Fixture

